

Pitch 3.2 ± 0.2 (P) ⊕

⊕ EXTENT OF A MINIMUM OF 1,5 TURN (540°) AT FULL THREAD DEPTH

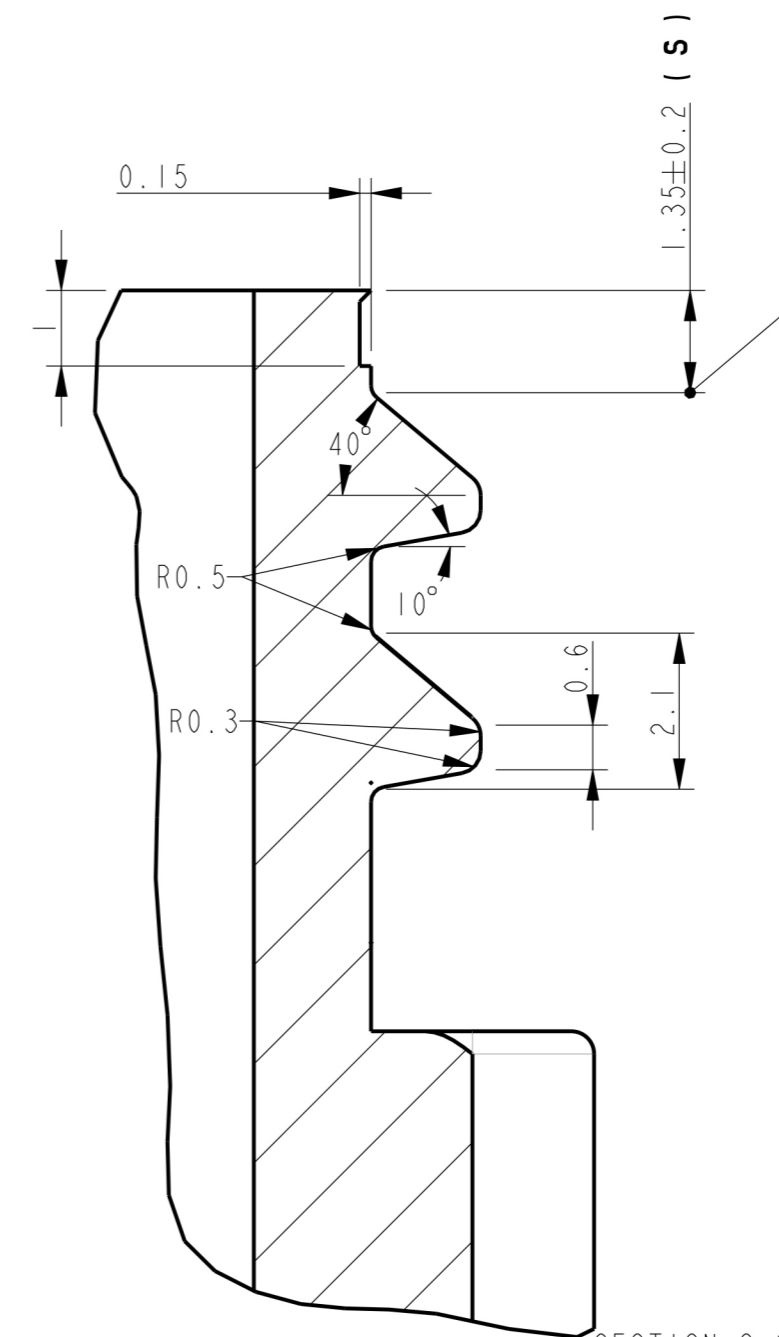

THE STARTING POINT OF THE THREAD MUST BE PLACED AS HIGH AS POSSIBLE IN ORDER TO ALLOW A BETTER ENGAGEMENT OF THE SCREW COLLAR THREAD

SECTION C-C
SCALE 10

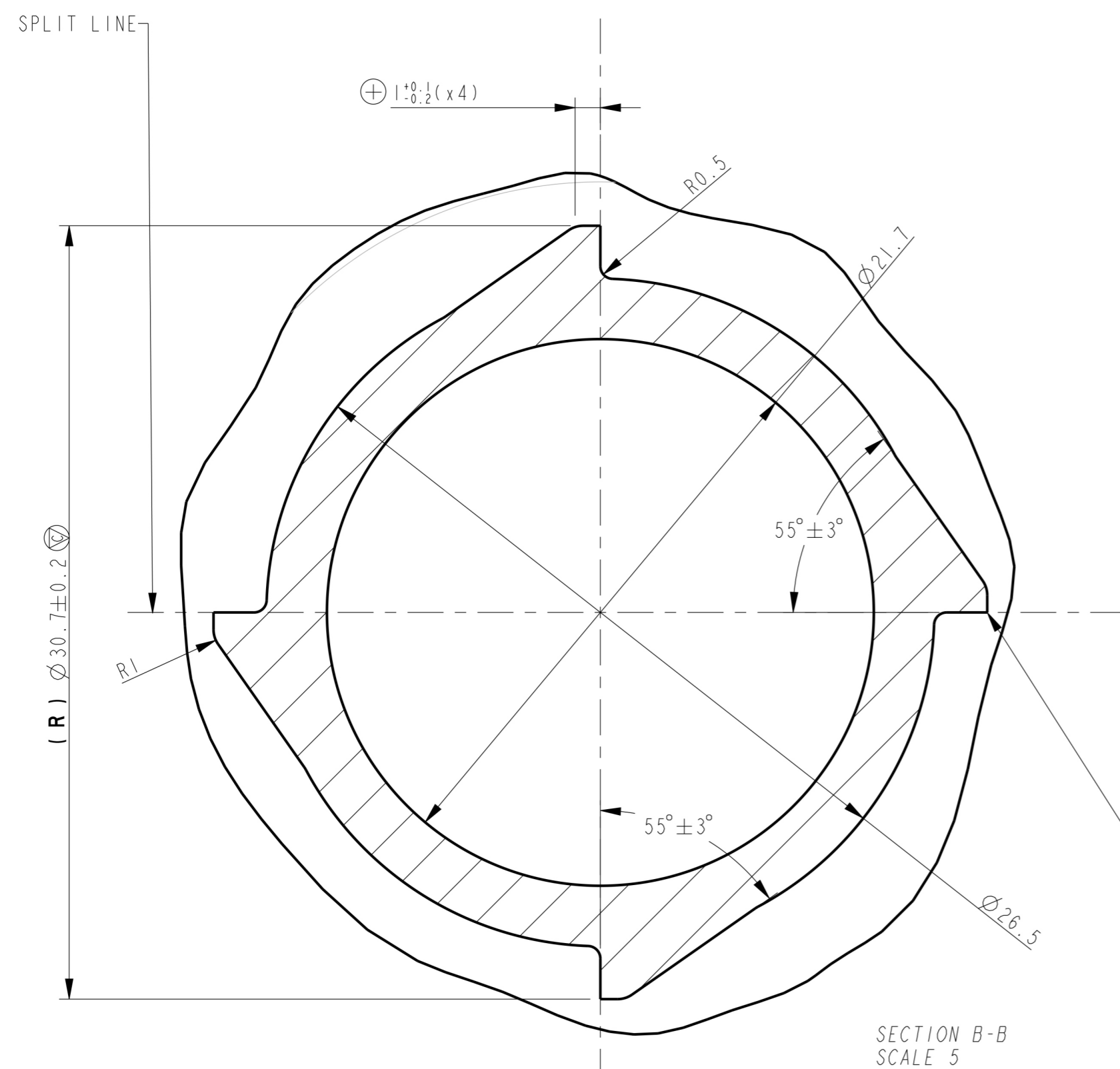

1. DIMENSION "H" IS MEASURED FROM THE TOP OF THE FINISH TO THE POINT WHERE DIAMETER "T", EXTENDED PARALLEL TO THE CENTERLINE, INTERSECTS THE SHOULDER (OR THE BEAD OPTIONAL)
2. UNLESS OTHERWISE SPECIFIED, "I" MIN APPLIES TO THE FULL LENGTH OF THE OPENING
3. CONCENTRICITY OF "I" MIN WITH RESPECT TO THE DIAMETERS "T" AND "E" IS NOT INCLUDED "I" MIN IS SPECIFIED FOR FILLER TUBE ONLY.
4. "T"- "R" AND "E" DIMENSIONS ARE THE AVERAGE OF TWO MEASUREMENTS TAKEN 90° APART. THE LIMITS OF OVALITY WILL BE DETERMINED BY THE CONTAINER SUPPLIER AND CONTAINER CUSTOMER, AS NECESSARY.
5. TOP SURFACE MUST BE FREE OF DEFECTS

SHARP EDGE ON MOULD
A MINIMUM RADIUS (R0.3mm MAX) IS ALLOWED

SECTION B-B
SCALE 5

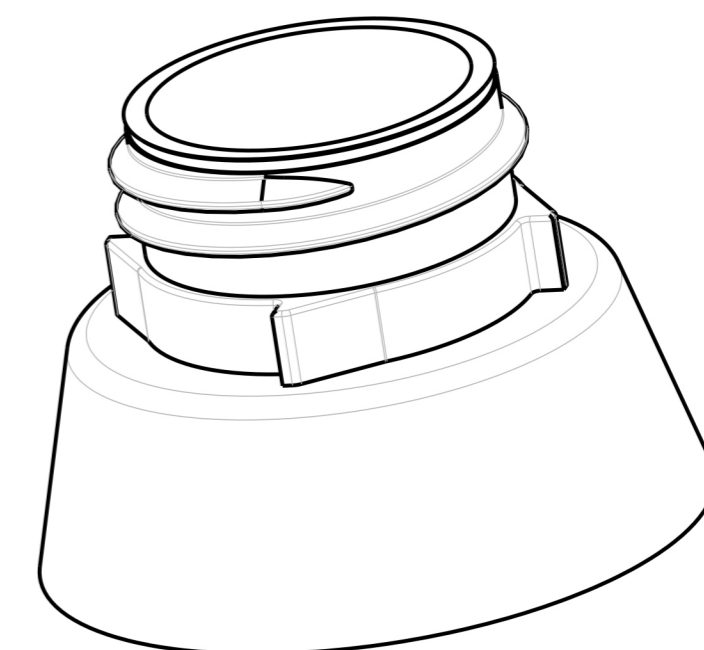

MODIFICHE		INTERVENTO	
VERS. n.	DATA	DIS.	AC
00	24/05/2013	AC	
01	02/03/2015	PC	

FIRST ISSUE (IT COMES TO S33RG11A-00)
DRAWING LAYOUT UPDATING

CLASSIFICAZIONE IMPORTANTE	REGOLAMENTATA	RAGGI NON INDICATI = R0.2 SMUSSI NON INDICATI = Sm 0.2x45° TOLLER. ANGOLI DA 0° A 6° = ±20" TOLLER. ANGOLI > 6° = ±1°	TOLLERANZE SECONDO UNI ISO 8015 SALVO ALTRIMENTI INDICATO QUOTE < 0.5 = ±0.05 QUOTE > 0.5 < 1 = ±0.07 QUOTE > 1 = TOLL. GENERALI ISO IT (JS-j1113)	LE QUOTE INDICATE IN PARENTESI SONO PURAMENTE COSTRUTTIVE QUINDI NON SONO SOGGETTE A RILIEVI DIMENSIONALI SALVO ALTRIMENTI INDICATO	DIS.: DRAW AC	SCALE: SCALE
CHARACTERISTIC'S CLASSIFICATION	IMPORTANT PRESCRIBED	NOT DIMENSION RADIUS = R0.2 UNLESS OTHERWISE NOTED NOT DIMENSION CHAMFER = Sm 0.2x45° ANGLE TOLERANCE 0° TO 6° = ±20" ANGLE TOLERANCE > 6° = ±1°	ALLOWANCES UNI ISO 8015 UNLESS OTHERWISE NOTED DIMENSION < 0.5 = ±0.05 DIMENSION > 0.5 < 1 = ±0.07 DIMENSION > 1 = GENERAL ALLOWANCES ISO IT (JS-j1113)	DIMENSIONS WRITTEN IN PARENTESIS ARE ONLY CONSTRUCTIONAL AND ARE NOT TO BE TAKEN DURING THE MEASUREMENT, UNLESS OTHERWISE NOTED	DATE: 24/05/2013	
MODELLO:	MODEL:	UNREMOVABLE SCREW NECK FINISH FOR DOUBLE GASKET VERSION 8 T.P.1 - PP CYLINDRICAL SCREW COLLAR VERSION EBM VERSION			MATERIALE: PEHD	
CODICE:	CODE:	UFFICIO TECNICO DI PROGETTAZIONE (R&D)			MATERIALE: RITIRO SHRINKAGE	
Questo disegno e' di riservato dominio della Gualodispensing S.p.A. Spinetto Marengo - Alessandria - Italy Ogni sua riproduzione o diffusione e' rigorosamente vietata. All proprietary right reserved by Gualo dispensing S.p.A. Spinetto Marengo - Alessandria - Italy Any reproduction or diffusion is strictly forbidden.					PESO: WEIGHT	